



SELSPORTS

ROOFTOP SPORTS SURFACES

RESIN BOUND GRAVEL ROOF TERRACE SURFACE

SELSports can offer a resin bound gravel surface that will replicate macadam. The surface has good slip resistance and provides an efficient permeable surface. There are a range of colours and aggregate types available to suit any end use and will help to create a relaxing communal social zone. The system is ideal to use for irrigation of planted zones.

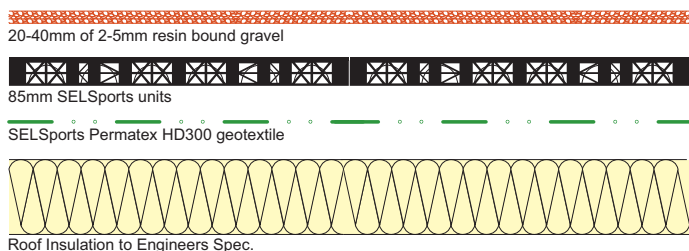

Typical Resin Bound Gravel Construction

RBG is a great alternative to macadam, raw materials can be transported to the rooftop individually and mixed in-situ. Whereas due to the logistically challenging location on a roof makes maintaining the working temperature of a macadam very difficult and expensive. The SELSports RBG option offers a lightweight permeable paving solution for rooftop social and recreational areas.

Typical Loadings

- Resin Bound Gravel - 30-50kg/m²
- 85mm SELSports units - 10kg/m²
- SELSports Permatex HD300 - 0.3kg/m²

Slip Resistance

- Average wet PTV 68
- Average dry PTV 78



Benefits

- Permeable, rainwater efficiently passes through the finished surface
- Long lifespan, the resin and aggregates are specially selected for durability
- Fast installation, a 2 man gang can lay 30m² or more per hour and, with good weather conditions, a gang of 5 men would expect to cover 250m² in a single day
- Choice, There are a huge choice of aggregates and colours
- UV Stable, the finished surface is UV stable and not affected by oil or fuel spillages
- Flexible, Once set, the wearing course exhibits some flexibility enabling it to resist cracking
- Wheelchair friendly, making it ideal for DDA schemes

SELSports, Canal House, Bonsall Street,
Blackburn BB2 4DD Tel: 01254 589987