



# SELSPORTS

## ROOFTOP SPORTS SURFACES

### RESIN BOUND GRAVEL SPORTS SURFACE

SELSports offer a Sport England compliant resin bound gravel surface that will replicate macadam. The surface meets the slip resistance criteria required for Sport England compliance and provides an efficient permeable surface. There are a range of colours and aggregate types to suit any end use from MUGA, playground or communal social zones.

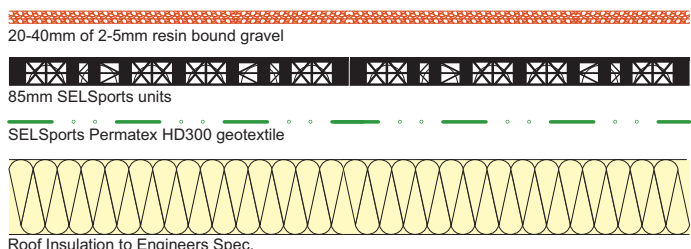

Typical Resin Bound Gravel Construction

RBG is a great alternative to macadam, raw materials can be transported to the rooftop individually and mixed in-situ. Whereas due to the logistically challenging location on a roof makes maintaining the working temperature of a macadam very difficult and expensive. The SELSports RBG option offers a lightweight permeable paving solution for rooftop social and recreational areas.

#### Typical Loadings

- Resin Bound Gravel - 30-50kg/m<sup>2</sup>
- 85mm SELSports units - 10kg/m<sup>2</sup>
- SELSports Permatex HD300 - 0.3kg/m<sup>2</sup>

#### Slip Resistance

- Average wet PTV 68
- Average dry PTV 78



#### Benefits

- Permeable, rainwater efficiently passes through the finished surface
- Long lifespan, the resin and aggregates are specially selected for durability
- Fast installation, a 2 man gang can lay 30m<sup>2</sup> or more per hour and, with good weather conditions, a gang of 5 men would expect to cover 250m<sup>2</sup> in a single day
- Choice, There are a huge choice of aggregates and colours
- UV Stable, the finished surface is UV stable and not affected by oil or fuel spillages
- Flexible, Once set, the wearing course exhibits some flexibility enabling it to resist cracking
- Wheelchair friendly, making it ideal for DDA schemes

SELSports, Canal House, Bonsall Street, Blackburn BB2 4DD Tel: 01254 589987